

REV.	ECN.NO.	DATE
A	RELEASED	10/13/09

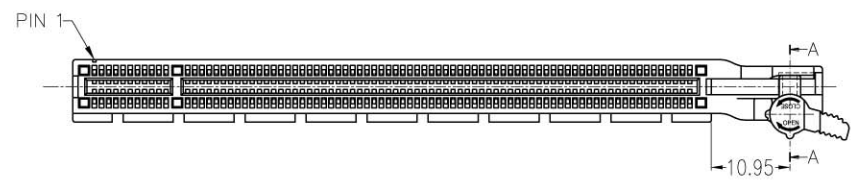

NOTES:

***Material**

Body : Nylon6T or Nylon9T, UL 94V-0 Rated.
 Rotational Pin: Nylon66,UL 94V-2 Rated.Color: White or Yellow.
 Contacts: Brass.
 Plating: Gold plating over Nickel(40~80u") on contact area;
 Tin(100~250u") plating on Solder Tail.

***Mechanical:**

Insertion Force: 1.15N Max Per Contact Pair.
 Withdrawal Force: 0.15N Min Per Contact Pair.
 Contact Retention Force: 4.9N Min Per Contact.

***Electrical Specification**

Contact Resistance : 30mΩ Max.
 Current Resistance: 1.1 Ampere.
 Insulation Resistance : 1000MΩ Min,At 500V AC.
 Operating Temperature: -55°c to +105°c.

***How to order:**

WPPS-164AN61B41UWL

- L:Left
- W:Winning Mark
- U:Lead Free
- 1:None Post
- 4:Straddle Type
- B:Brass
- 1:Black
- N6: Nylon6T N9:Nylon9T
- Gold A:Flash B:5u" C:10u" D:15u"
- Number of contacts:164Pin
- Series NO.

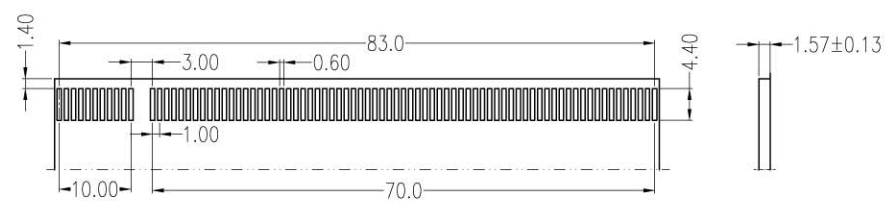
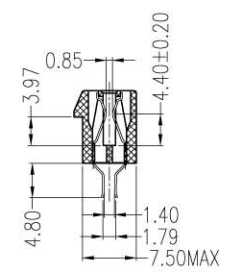
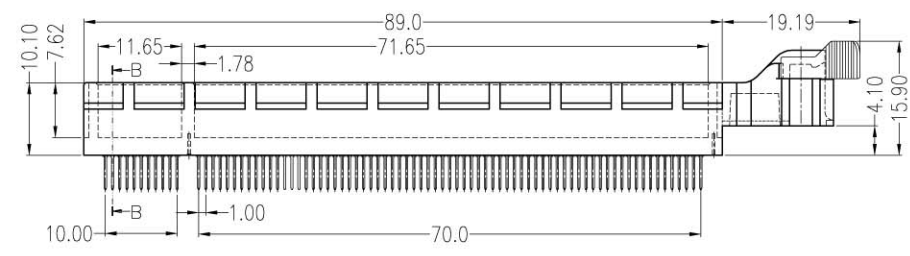

P.C.B. Layout For Straddle

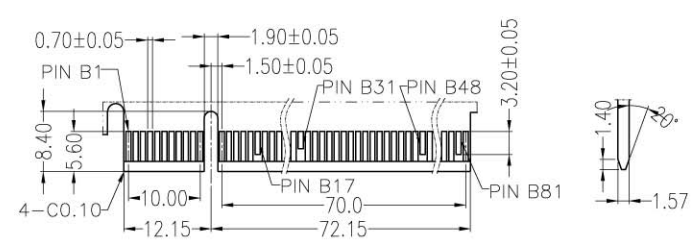

PRIMARY (COMPONENT) SIDE

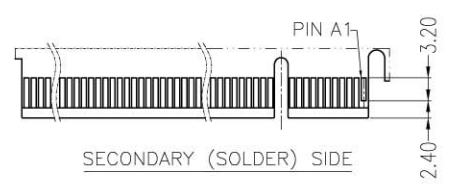

SECONDARY (SOLDER) SIDE

REV				Drawing By	Data		
Units	mm	Scale	1:1	Reviewed By	Data	Date	10/13/09
Tolerance Unless Otherwise Specified				Approval By	Data	Sheet	1 of 1
.X	~	±0.38				Third Angle Projection	
.XX	~	±0.25				⊗	
.XXX	~	±0.20				□	
Angle	~	± 3°				Title	PCI Express 164 Pin Left Rotational Strip Form Pin Straddle(None Post)
						Drawing No.	
						REV	A